

Removing PRV

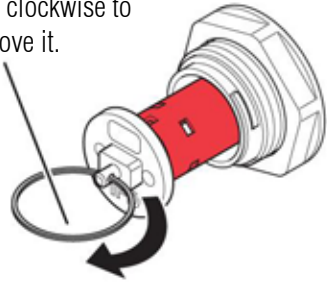

- 1** Twist PRV pull ring clockwise to remove it.



- 2** Remove PRV cover.

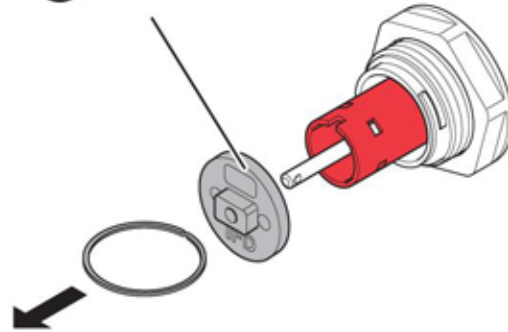

- 3** Push temporary shipping lock onto PRV shaft to disengage PRV.

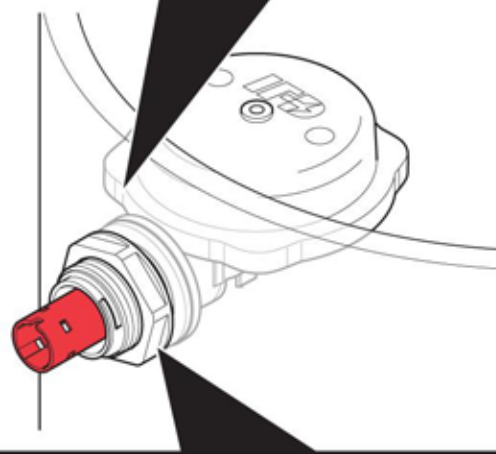
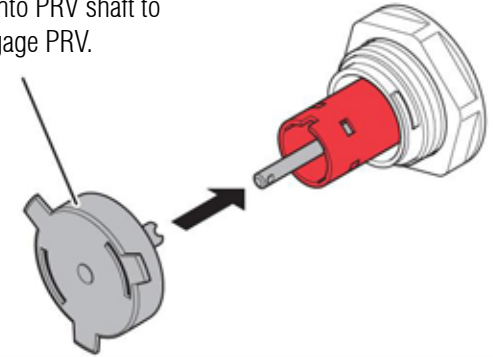

- 4** Turn temporary shipping lock 45° clockwise.

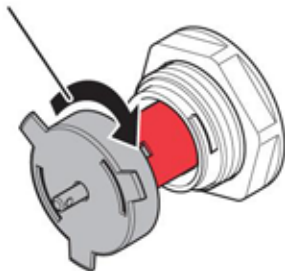

- 5** Remove temporary shipping lock and PRV from IFD indicator.

